

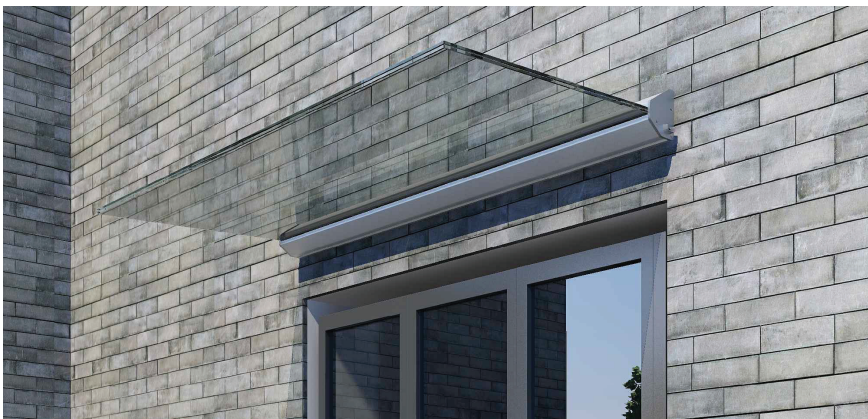

SMART REKKVERK

MONTERINGSANVISNING



OPTIONAL: LED light set

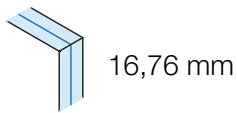

16,76 mm

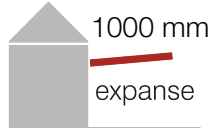

1000 mm
expansion







max. 1,5kN / m²
load

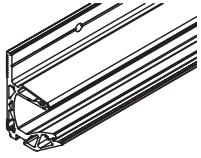

NO glass-machining needed

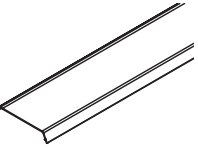
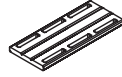
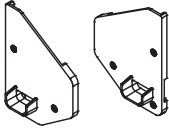
Scope of supply

 1x	 1x	 1x	 16x (29.205x.175.46) 24x (29.205x.250.46) 40x (29.205x.500.46)	 1x	 1x (29.205x.175.46) 1x (29.205x.250.46) 2x (29.205x.500.46)
---	---	---	---	---	--

Mounting tools:

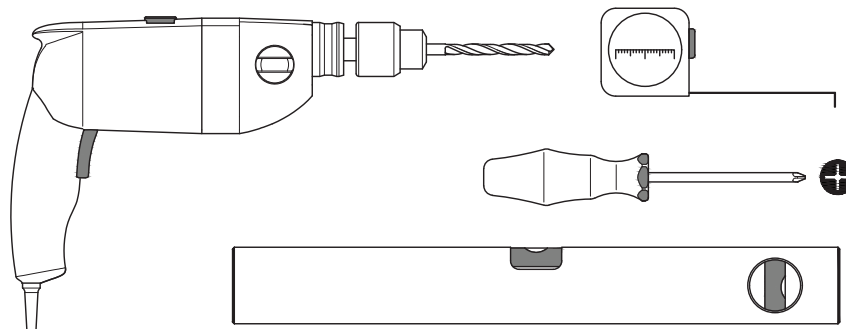

1.

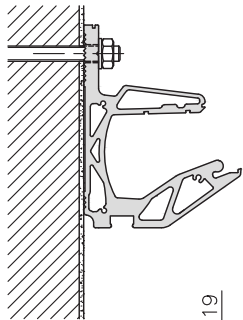

Fasten the base profile to the wall with statically suitable fixing anchors*. All mounting holes must be used at a distance of 250mm.

If necessary, the mounting pipe for external wall insulation can be shortened to the required lengths and mounted. (Art. No.: 44.1299.028.00 - not included in delivery)

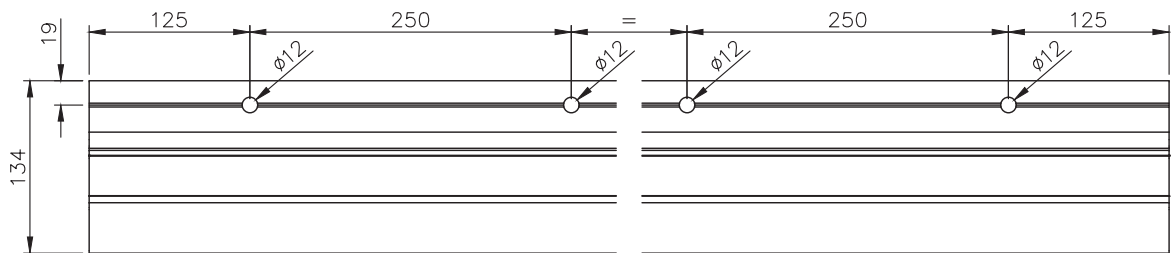

OPTIONAL: 44.1299.028.00

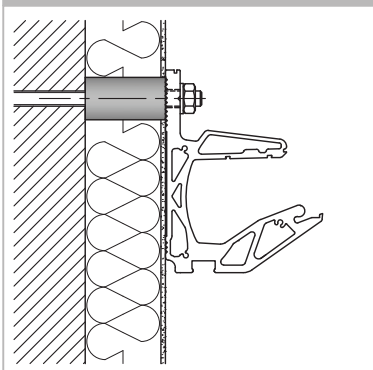

* The usability of the screws must always be checked by the installer and adapted to the condition of the load-bearing structure. We expressly accept no liability for damage resulting from improper installation. Installation should only be carried out by a specialist.

2.

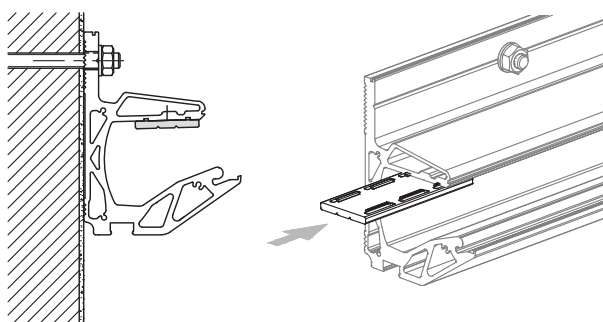

Insert the upper clamping plates into the base profile. The number of clamping plates varies depending on the profile length. Spacing according to Figure A.

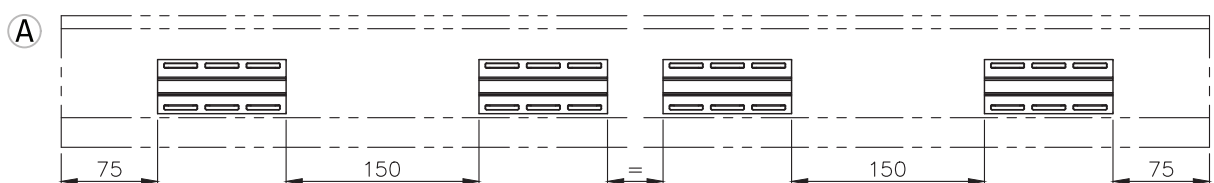

3.

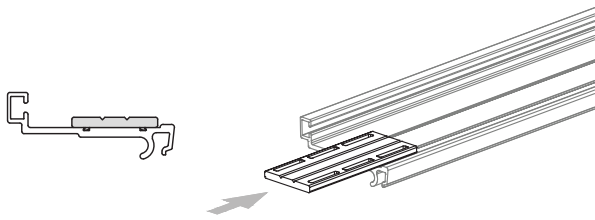

Insert the lower clamping plates into the clamping profile. The number of clamping plates varies depending on the profile length. Spacing according to figure B.

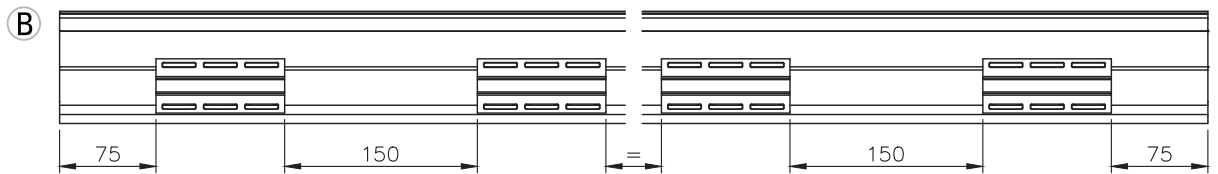

4.

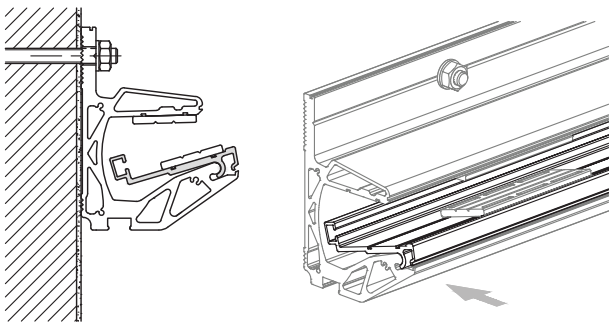

Insert the clamping profile into the base profile.

5.

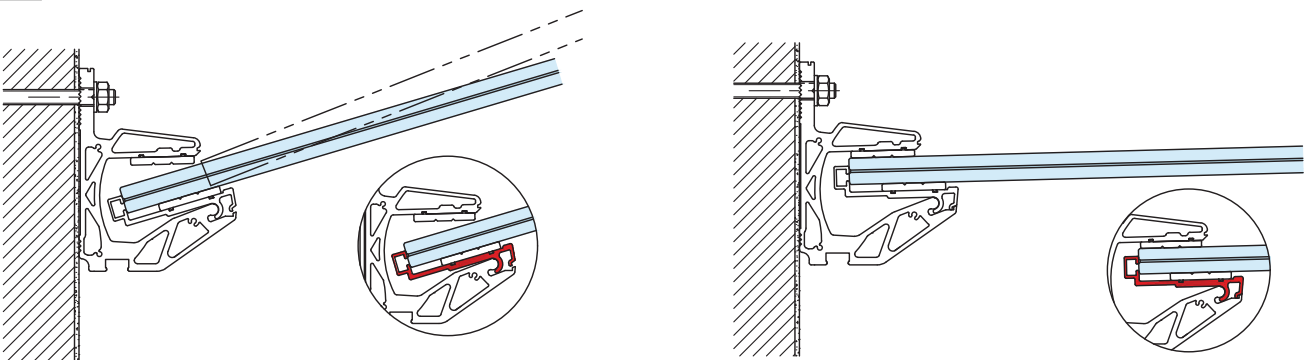

Glass Installation: Place the glass pane slightly angled between the base and clamping profiles. The glass must touch the rear edge of the clamping profile. The glass is then slowly returned to its horizontal position. Please note that the clamping profile with the glass tilts upwards and the glass is wedged between the upper and lower clamping plates.

6.

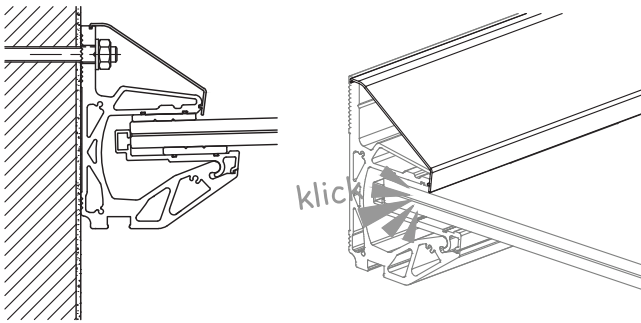

Install the cover profile: Insert the profile into the upper groove and press it into the lower groove. The cover profile is 10mm longer than the base profile and must extend 5mm on both sides.

7.

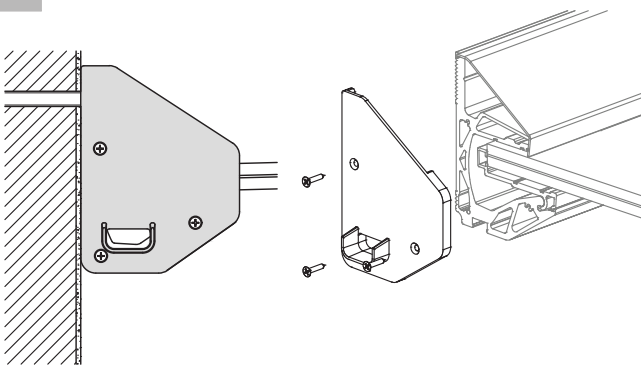

Place the end caps right and left on the profile and fasten with the screws. Make sure that the locking pin of the cap is wedged between the base profile and the clamping profile.

! We recommend sealing the marked areas with silicon.

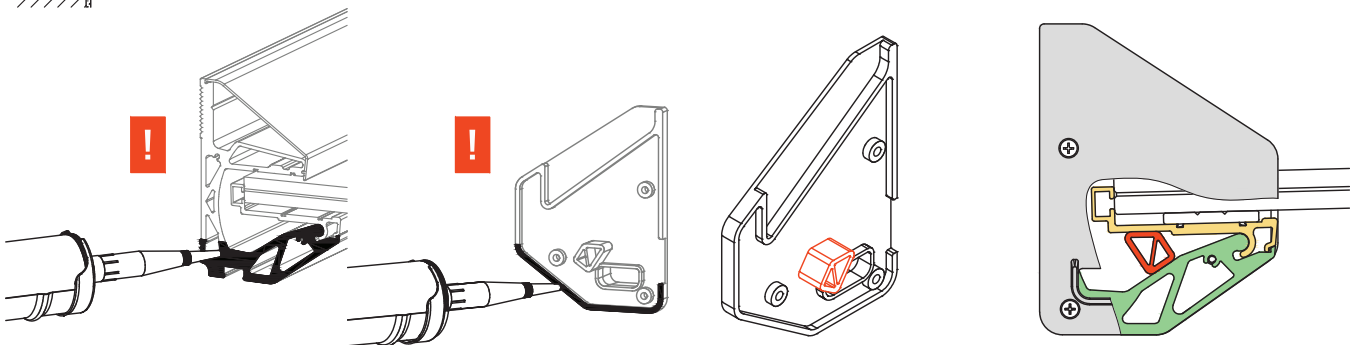

8.

